



OUTLINE DIMENSIONS

3-PHASE INDUCTION MOTOR

FRAME NO :

D315MC

| POLES | HP | KW | SYNCH RPM |
|-------|---------|---------|-----------|
| 4 | 200/250 | 150/185 | 1500 |
| 6 | 150/175 | 110/132 | 1000 |
| 8 | 125 | 90 | 750 |
| | | | |

TOTALLY ENCLOSED FAN-COOLED TYPE. SQUIRREL-CAGE ROTOR

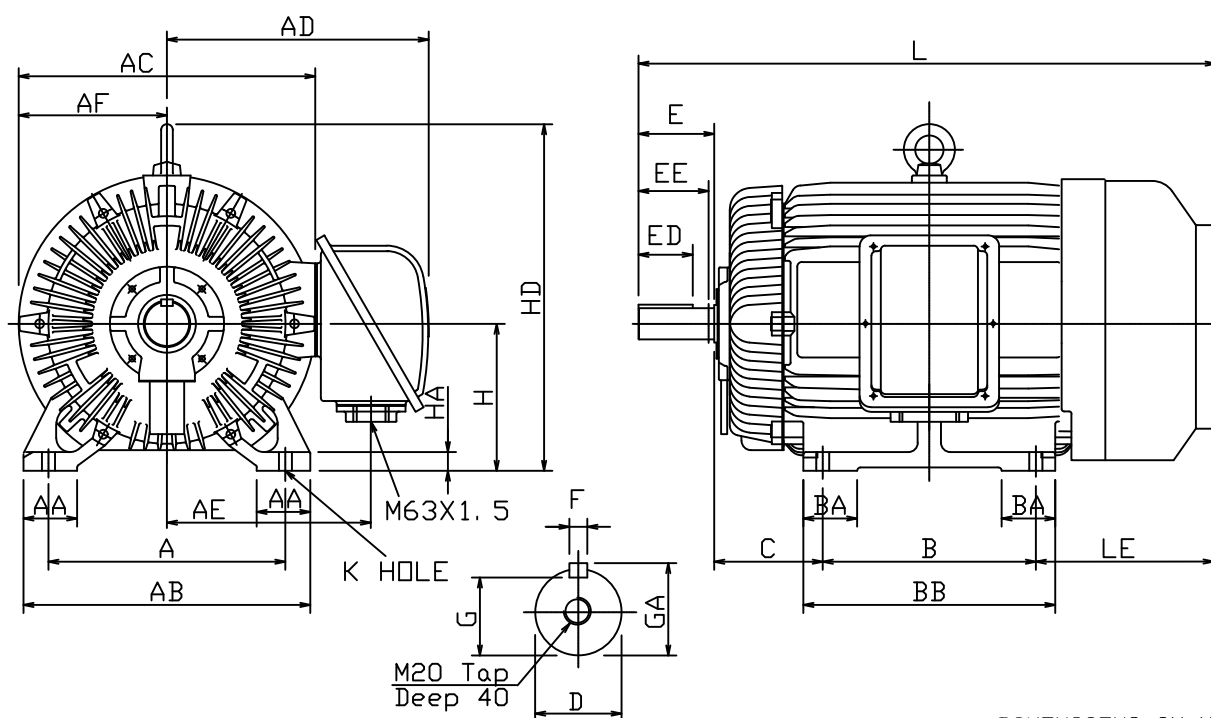

DIMENSIONS IN MM

| FRAME NO. | | A | AA | AB | AC | AD | AE | AF | B | BA | BB | C |
|-----------|-----|-----|-----|-----|-----|-----|-----|-----|-----|-----|------|-----|
| 315MC | | 508 | 115 | 615 | 642 | 620 | 465 | 312 | 457 | 115 | 540 | 216 |
| D | E | ED | EE | F | G | GA | H | HA | HD | K | L | LE |
| 85 | 170 | 140 | 157 | 22 | 76 | 90 | 315 | 40 | 723 | 28 | 1212 | 369 |

NOTES:

1. FOOT MOUNTED IM1001.
2. TYPICAL DIMENSIONS ONLY
FOR CERTIFIED DIMENSIONS
REFER TO TECO.
3. FOR BELT OR DIRECT DRIVE.

FOR MAXe3MINING AND
MAXe3PREMIUM SEVERE DUTY

| | | | | |
|-------|----|------------|---|----------|
| DWN. | EJ | 01. 12. 15 | 東元電機股份有限公司 TECO ELEC. & MACH. CO., LTD. TAIWAN R. O. C. | REV : 00 |
| CHKD. | DK | 01. 12. 15 | | |
| APPD. | JF | 01. 12. 15 | | |